



Comfort lift jamming in upper position

AEG



Correct



White
guide
pin in
channel

R/H side:



Correct

White
guide
pin in
channel



L/H side:



Incorrect

White
guide pin
not in
channel

L/H side:





Incorrect

White
guide pin
not in
channel

White guide
pin dropped
into adjacent
slot

L/H side:

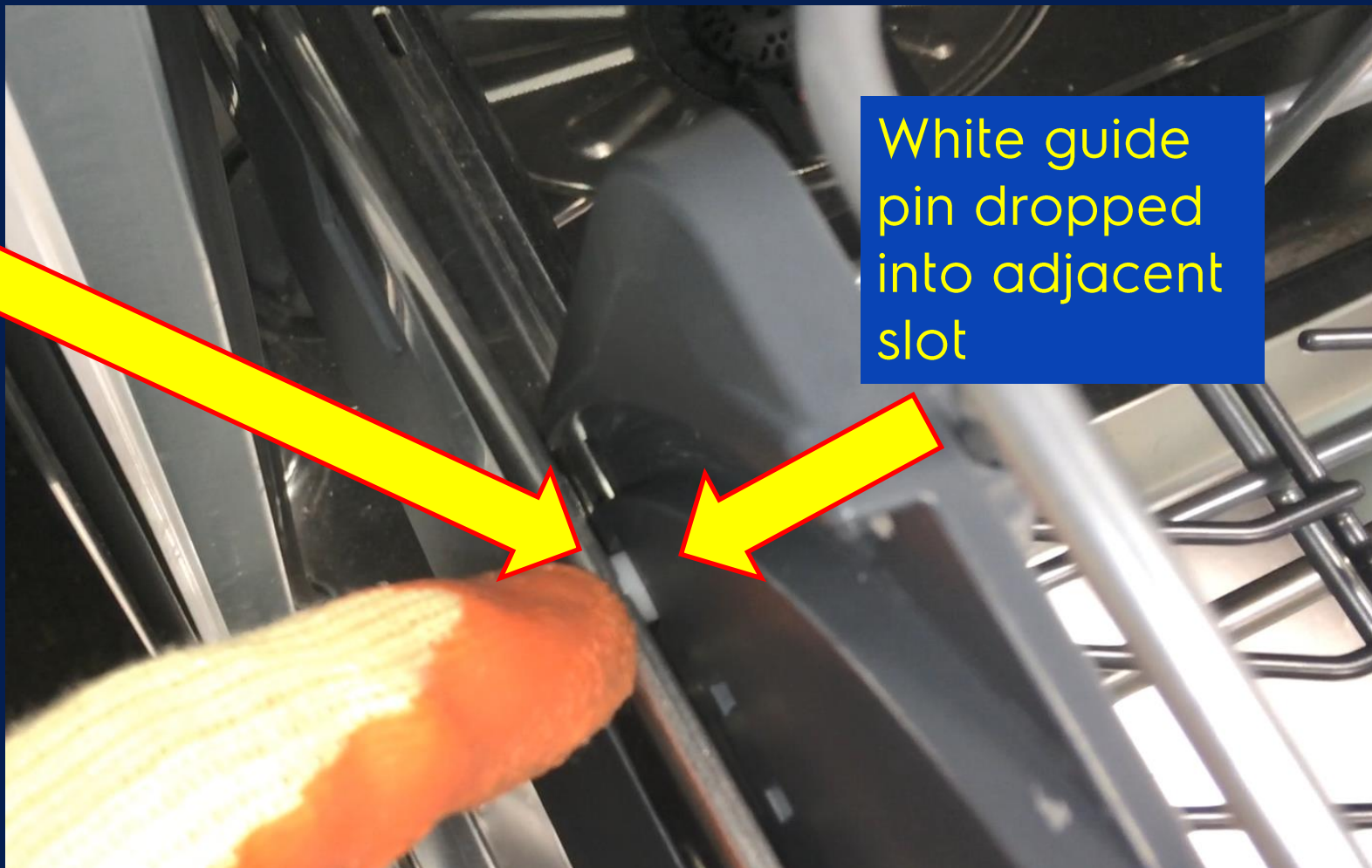



Repair

Ease the white guide pin out of the adjacent slot





Repair



Ease the white guide pin out of the adjacent slot

Apply opposing pressure onto the basket and side rail until the white pin is clear



Repair

Direct the pin back to the channel, once back in alignment ...





Repair

Direct the pin back to the channel, once back in alignment ...



...release the applied pressure to drop the white guide pin back into the correct position.



...the comfortlift should now
operate correctly.